

**EXAMPLE:**  
Component Parts (Small #)  
Are Included When Ordering  
The Assembly (Large #).

**LUBRICATION:**  
**Type 'Y' Grease, Item 1200**  
Liberal coat the teeth of the  
Armature Pinion (45).

Lightly coat the bearing bores  
of the Gearcase (41) prior to  
installing bearings (39 & 44).

Fill back end of Gear Housing  
Cover (35) with grease, making  
sure that the teeth of Gear (38)  
are completely covered.

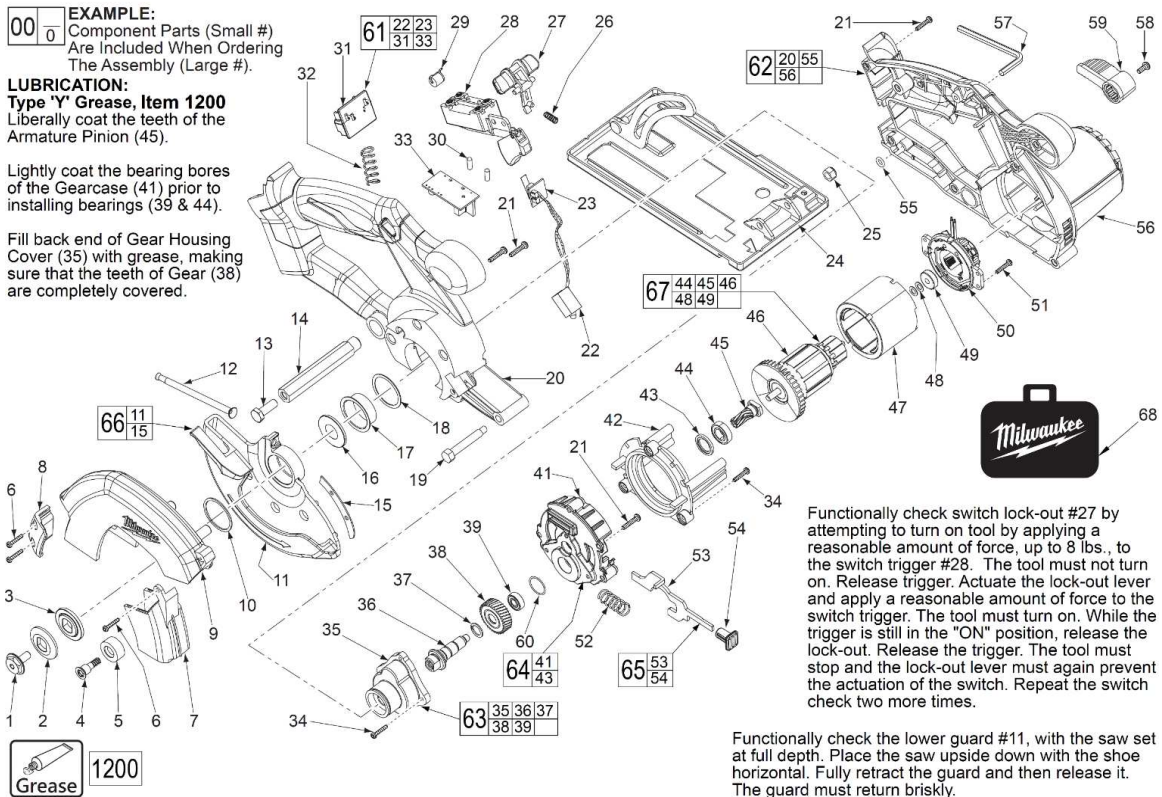

	<div> <b>HD18 MS</b>  SERVICE PARTS LIST  TTI Model Number: 018 041 016  <b>M18™ HEAVY DUTY METAL CUTTING SAW</b> </div>	<div> <b>Bulletin Date:</b>  <b>May-18</b>  <b>Starting Serial Number:</b>  <b>VERSION A - C2014</b> </div>
---	--	---

ITEM	PART NUMBER	PART DISCRIPTION	QTY (PCS)
1	661263001	BLADE SCREW	1
2	611280001	OUTER FLANGE	1
3	611281001	INNER FLANGE	1
4	661354001	BUMPER SCREW	1
5	561506003	RUBBER BUMPER	1
6	661414002	M3 X 10MM SCREW	3
7	521896001	TRANSPARENT WINDOW	1
8	521898001	GUARD COVER	1
9	350893001	UPPER GUARD	1
10	692692001	RETAINING RING	1
11	-	LOWER GUARD	1
12	692687001	SPRING	1
13	660995001	1/4" X 20MM UNC SCREW	1
14	692774001	HEXAGON BAR	1
15	-	LOWER GUARD PLATE	1
16	633585001	DUST SEAL	1
17	633602001	SLEEVE	1
18	633603001	WASHER	1
19	661020001	SHOULDER BOLT	1
20	-	HOUSING SUPPORT	1
21	660031017	M3.5 X 15MM SCREW	12
22	-	LED ASSEMBLY	1
23	-	MICRO SWITCH WITH PCB	1
24	304011001	SHOE ASSEMBLY	1
25	660163005	LOCK NUT	1
26	672029001	LOCK OUT SPRING	1
27	521895001	SWITCH LOCK OUT	1
28	760245005	SWITCH	1
29	290705002	DIODE	1
30	560085001	RUBBER PIN	2
31	-	BATTERY TERMINAL BLOCK	1
32	691093001	TERMINAL BLOCK SPRING	2
33	-	PCB ASSEMBLY	1
34	660211016	M3.0 X 12MM SCREW	6
35	-	GEAR HOUSING COVER	1
36	-	SPINDLE	1

	<div> <b>HD18 MS</b>  SERVICE PARTS LIST  TTI Model Number: 018 041 016  <b>M18™ HEAVY DUTY METAL CUTTING SAW</b> </div>	<div> <b>Bulletin Date:</b>  <b>May-18</b>  <b>Starting Serial Number:</b>  <b>VERSION A - C2014</b> </div>
---	--	---

ITEM	PART NUMBER	PART DISCRIPTION	QTY (PCS)
37	-	RETAINING RING	1
38	-	SPINDLE GEAR	1
39	-	BALL BEARING	1
41	-	GEARCASE	1
42	521897001	BAFFLE	1
43	562656001	RUBBER SEAL	1
44	681456002	BALL BEARING	1
45	-	ARMATURE PINION	1
46	-	ARMATURE	1
47	741555002	FIELD	1
48	902207002	WASHER	2
49	681286002	BALL BEARING	1
50	290586003	BRUSH CARD ASSEMBLY	1
51	660851001	M3 X 16MM SCREW	4
52	692696001	SPRING	1
53	-	SPINDLE LOCK	1
54	-	LOCK BUTTON	1
55	561529001	O-RING	1
56	-	HOUSING COVER	1
57	691255001	3/16" HEX KEY	1
58	660997001	10-24 X 1/2" SCREW	1
59	521957001	DEPTH LEVER	1
60	562749001	O-RING	1
61	201508003	MICRO-SWITCH/PCBA/TERM. BLOCK ASSY.	1
62	201304003	HOUSING ASSEMBLY	1
63	201228002	HUB ASSEMBLY	1
64	201040004	GEARCASE ASSEMBLY	1
65	201498003	SPINDLE LOCK ASSEMBLY	1
66	201500002	LOWER GUARD ASSEMBLY	1
67	201220004	ARMATURE ASSEMBLY	1
68	902189012	CONTRACTOR BAG	1
69	941038239	RATING LABEL (NOT SHOWN)	1
1200	-	TYPE Y GREASE	1

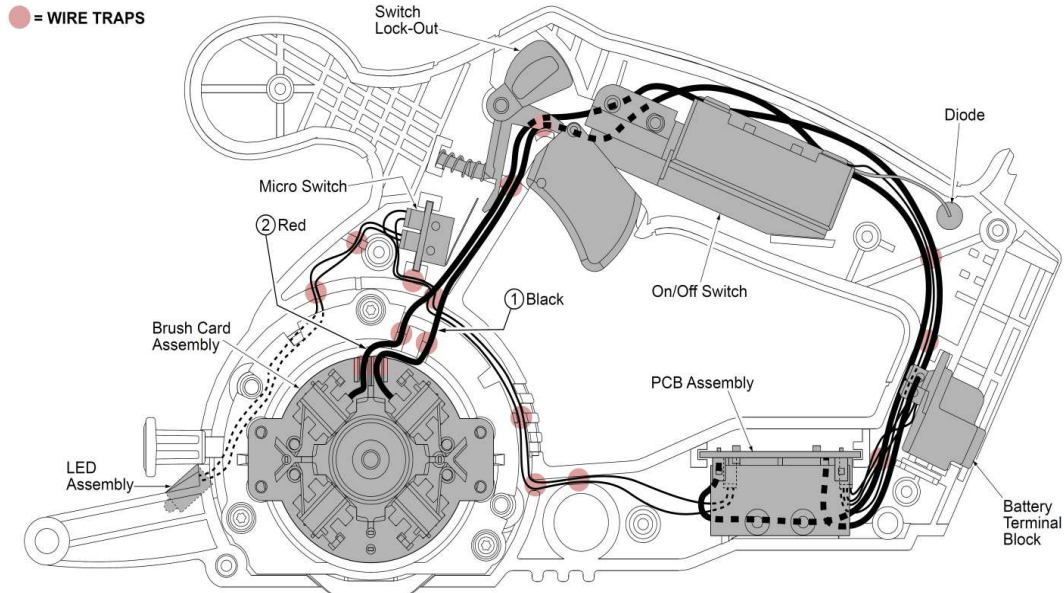

AS AN AID TO REASSEMBLY,  
TAKE NOTICE OF WIRE ROUTING  
AND POSITION IN WIRE GUIDES  
AND TRAPS WHILE DISMANTLING  
TOOL.

BE CAREFUL AND AVOID PINCHING  
WIRES BETWEEN HANDLE HALVES  
WHEN ASSEMBLING.

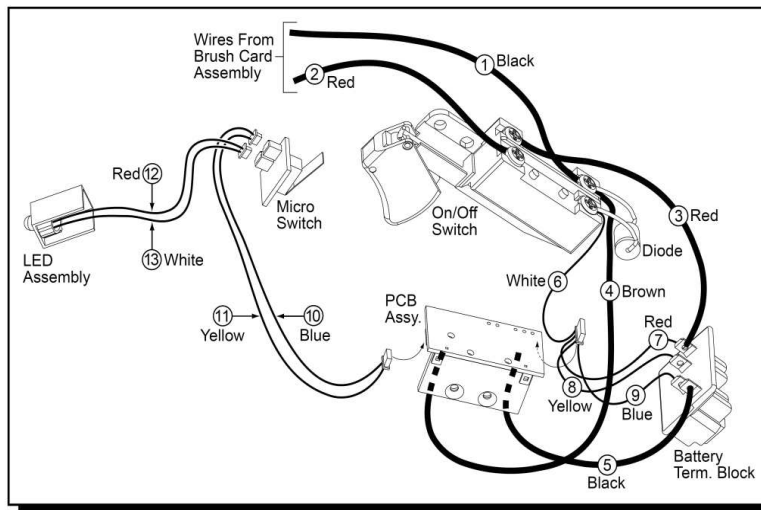

**WIRING SPECIFICATIONS**

Wire No.	Wire Color	Origin or Gauge	Length	Terminals, Connectors and 1 or 2 End Wire Preparation
1	Black	----	----	Component of brush card assy. Route to bottom right position on switch with # 4, under diode terminal.
2	Red	----	----	Component of the brush card assembly. Route to the top left position on switch.
3	Red	----	----	Component of the terminal block assembly. Route to top right position on switch.
4	Brown	----	----	Component of the PCB assembly. Route to bottom right position on switch With #1, under diode terminal.
5	Black	----	----	Component of the PCB assembly that is soldered to the battery terminal block as shown.
6	White	----	----	Component of 4 pin connector. Route to bottom left position on switch under diode terminal.
7	Red	----	----	Component of 4 pin connector. Soldered to battery terminal block with #3 as shown.
8	Yellow	----	----	Component of 4 pin connector. Soldered to battery terminal block as shown.
9	Blue	----	----	Component of 4 pin connector. Soldered to battery terminal block as shown.
10	Blue	----	----	Comp. of two 2 pin connectors. Attach to PCB at one end and the top position of micro switch at other.
11	Yellow	----	----	Comp. of two 2 pin connectors. Attach to PCB at one end and the top position of micro switch at other.
12	Red	----	----	Component of LED assembly. Attach connector block to bottom position of micro switch as shown.
13	White	----	----	Component of LED assembly. Attach connector block to bottom position of micro switch as shown.