



M12 TLED

SERVICE PARTS DIAGRAM

TTI Model Number: 016 003 106

M12™ LED TORCH

Bulletin Date:

Apr-20

Starting Serial Number:

VERSION A - E2016

00 0

EXAMPLE:

Component Parts (Small #) Are Included
When Ordering The Assembly (Large #).

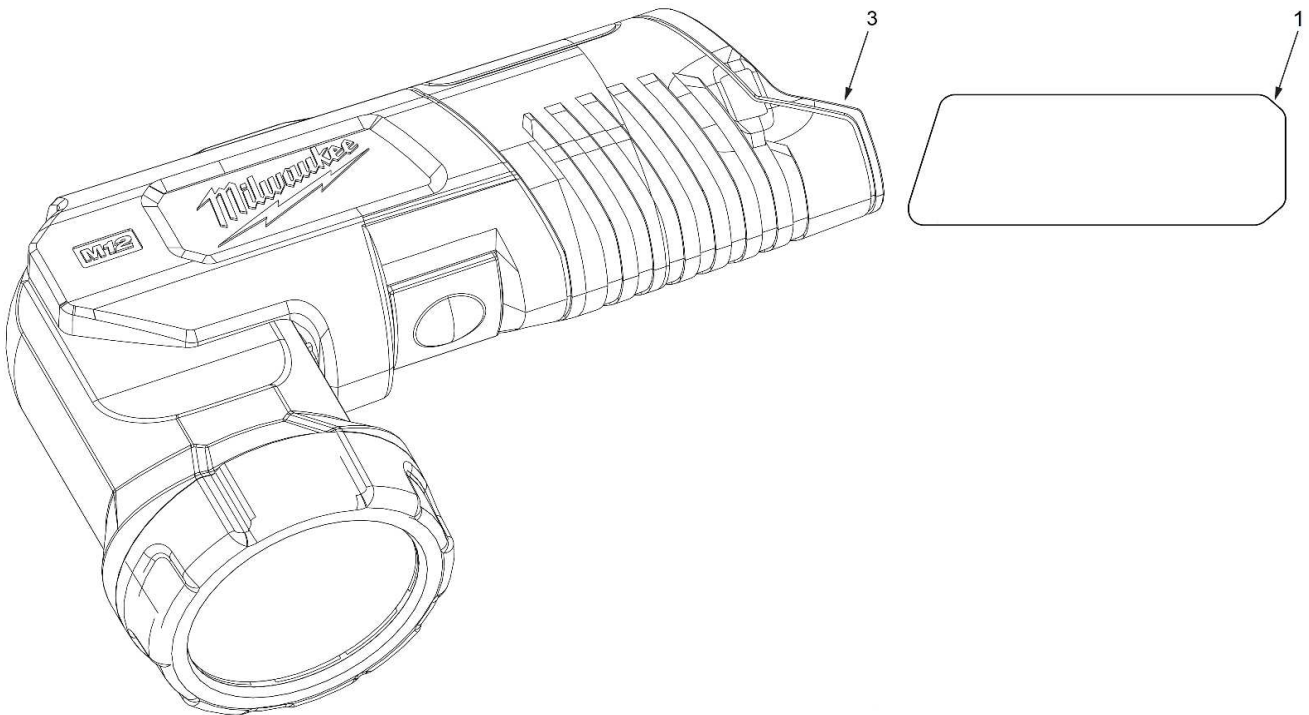
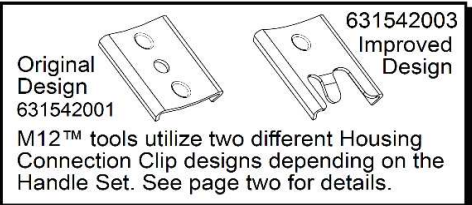

A clean, dry surface is essential for proper performance for any adhesive system. The area intended for application of any adhesive label or nameplate must be prepared by cleaning with isopropyl alcohol. The solvent is to be applied with a clean, lint free applicator and the surface allowed to dry before applying the label or nameplate.

	M12 TLED SERVICE PARTS LIST	Bulletin Date: Apr-20
	TTI Model Number: 016 003 106 M12™ LED TORCH	Starting Serial Number: VERSION A - E2016

ITEM	PART NUMBER	PART DESCRIPTION	QTY (PCS)
1	01600310601K	RATING LABEL	1