



M12 SI

SERVICE PARTS DIAGRAM

TTI Model Number: 016 077 006, 009

M12™ SOLDERING IRON

Bulletin Date:

Jul-20

Starting Serial Number:

VERSION A -

EXAMPLE:
Component Parts (Small #)
Are Included When Ordering
The Assembly (Large #).

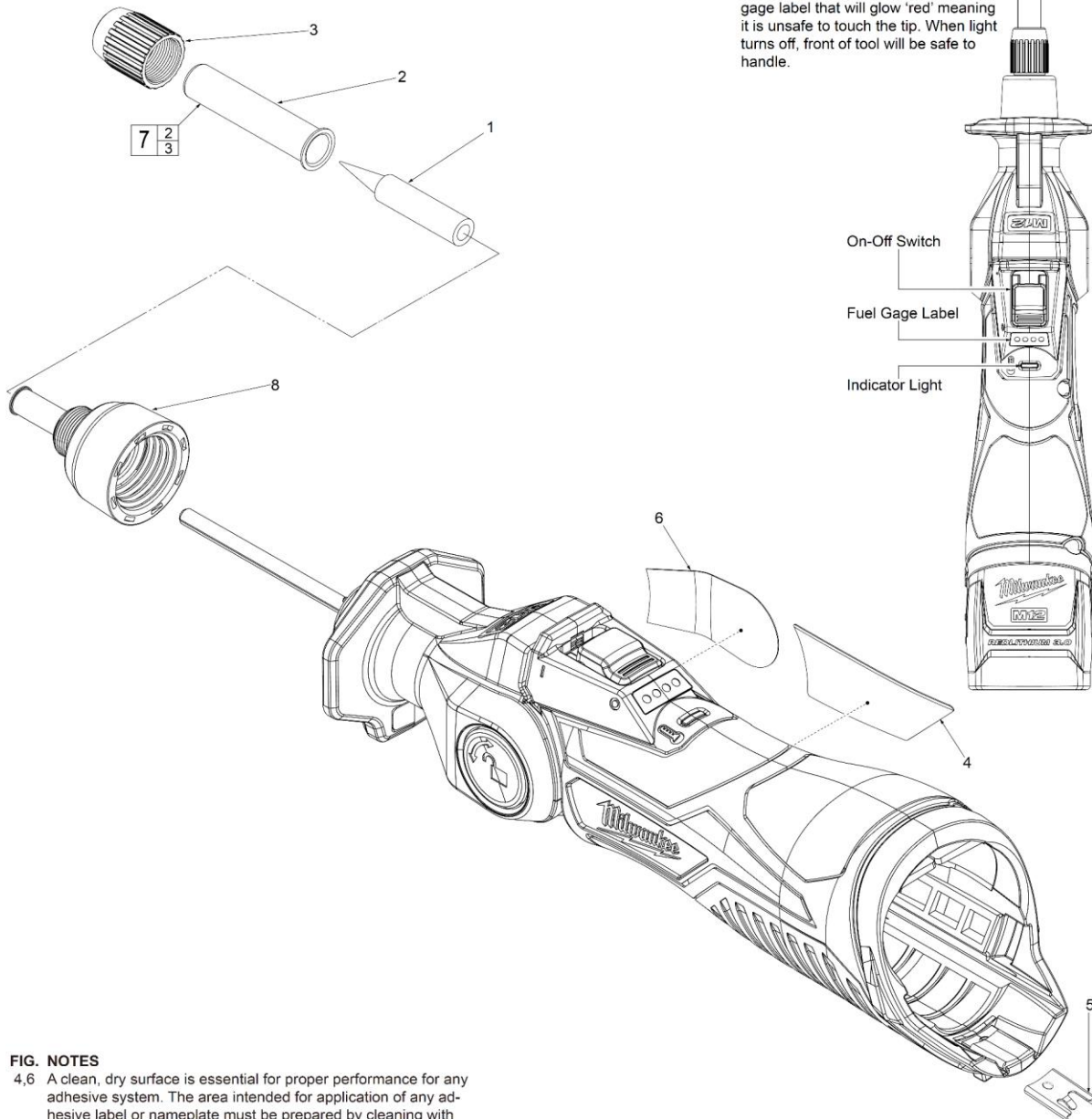

FIG. NOTES

4,6 A clean, dry surface is essential for proper performance for any adhesive system. The area intended for application of any adhesive label or nameplate must be prepared by cleaning with isopropyl alcohol. The solvent is to be applied with a clean, lint free applicator and the surface allowed to dry before applying the label or nameplate.

	M12 SI SERVICE PARTS LIST	Bulletin Date: Jul-20
	TTI Model Number: 016 077 006, 009 M12™ SOLDERING IRON	Starting Serial Number: VERSION A -

ITEM	PART NUMBER	PART DESCRIPTION	QTY (PCS)
1	016077001001	POINT TIP	1
2	016077002002	METAL TUBE	1
3	016077002001	FASTENER NUT	1
4	01607700601K	RATING LABEL 016077006 ASIA VERSION	1
4	01607700901K	RATING LABEL 016077009 APJ VERSION	1
5	631542003	HOUSING CLIP	1
6	01607700202K	WARNING LABEL	1
7	016077001003	GUARD/FASTENER SERVICE KIT	1
8	016077006001	PLASTIC NUT WITH METAL NUT	1